

Reva and David Logan Center for the Arts
University of Chicago

Schematic Lighting Design Presentation

Sean Kim
December 9, 2013

Overview

Building Type: Multidisciplinary arts center

Size: 184,000 square foot

Stories: 11-story tower with
3-story adjacent building

Owner: University of Chicago

Design Architect: Tod Williams Billie Tsien Architects

Lighting Design: Refro Design Group

MEP Engineer: Ambrosino Depinto & Schmieder
Consulting Engineering

Construction Manager: Turner Construction, LLC



Location

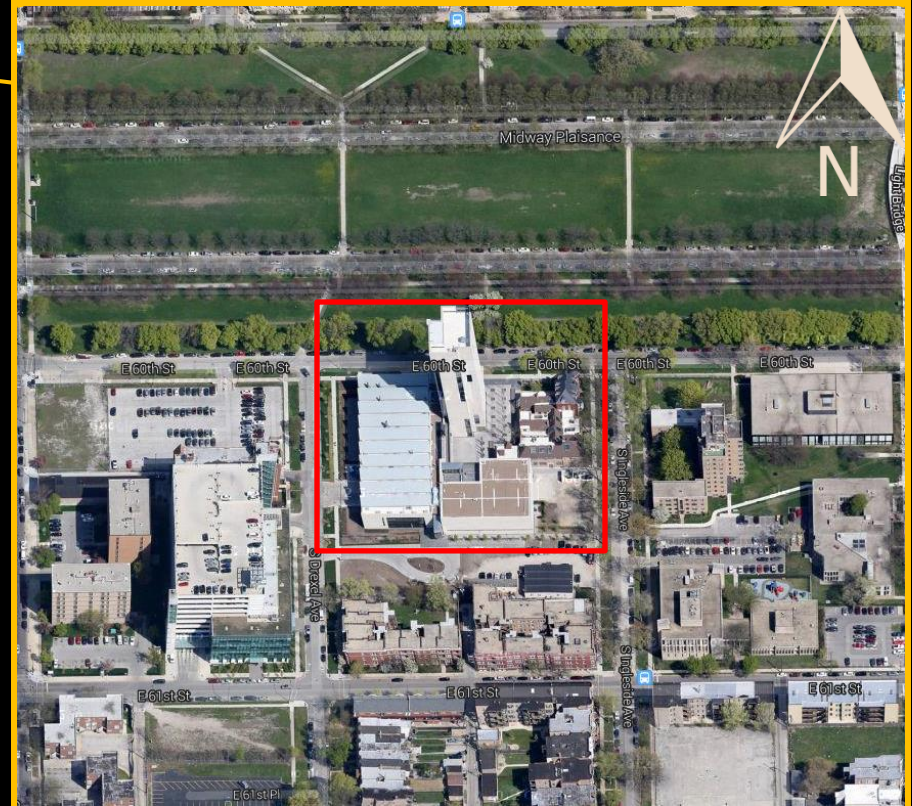
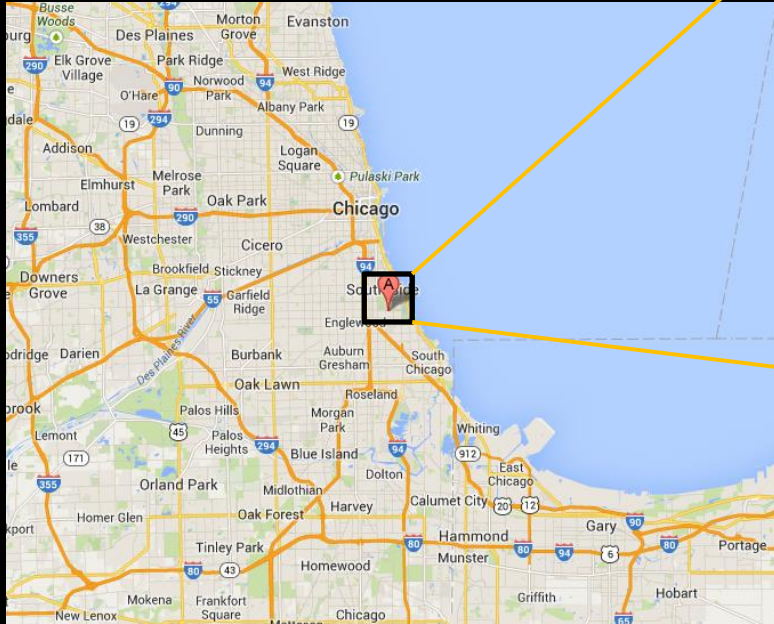

Location: 915 E 60th St, Chicago IL, 60637

Space overview

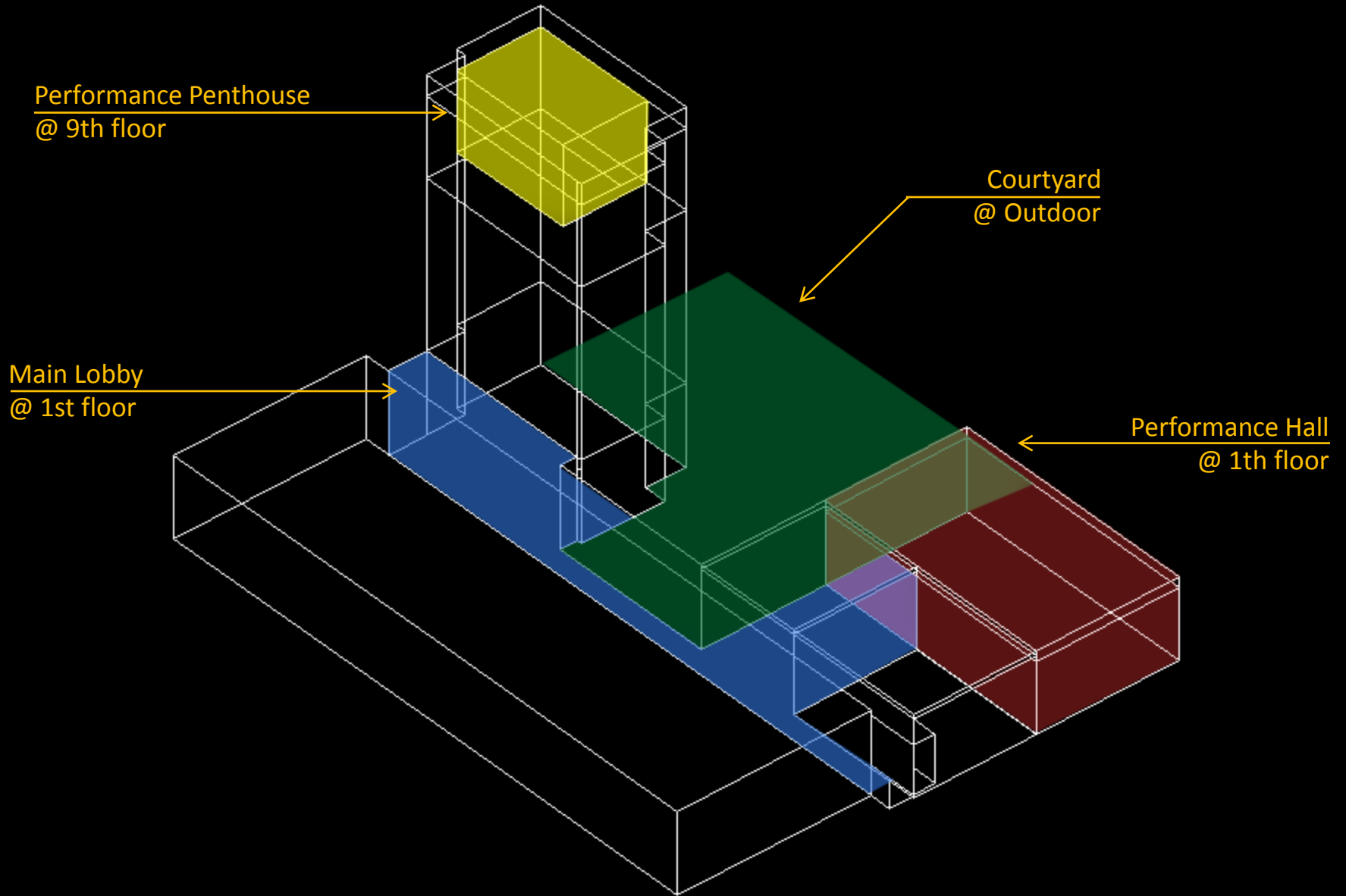

Design and Mission



- Larry Norman, Deputy Provost for the Arts

*“The David and Reva Logan Center for the Arts will add luster to the university’s already rich history of groundbreaking **artistic** exploration and accomplishment, and become a model of its kind on the national stage.”*



- Tod Williams & Billie Tsien, Architects

*“The idea of the low, sky lit building of studios and theaters, and the tower of the arts came from imagining the **flat prairies of the Midwest** and the great towers of Chicago.”*



- From the mission of Logan Family

The Reva and David Logan Center for the Arts advances arts practice, inquiry, and presentation at the University of Chicago, and fosters meaningful collaboration and **cultural** engagement at the university, on the south side, and in the city of Chicago.

Design and Mission



The Reva and David Logan Center for the Arts is fully operational as a vibrant home for the study, practice, and presentation of arts at the UChicago.

- From the Design of Logan Center for the Arts

HARMONY



artistic



flat prairies of the Midwest



cultural



vibrant

Main Lobby



Space purpose

- Primary Entrance
- Circulation
- Gallery
- Exhibition

Design goal

- Create welcoming environment
- Powerful atmosphere
- Flexible lighting system
- Way finding

Main Lobby | *flat prairies of the Midwest*

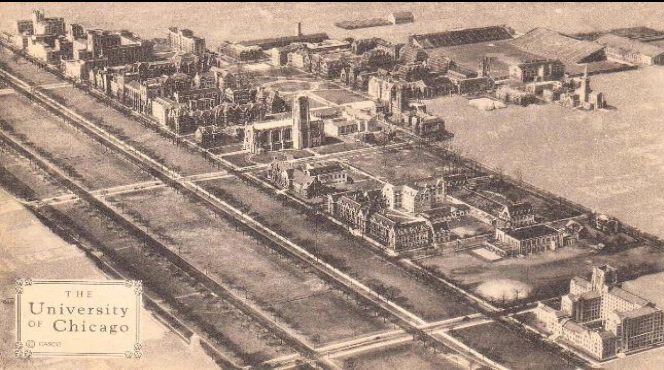

Main Lobby

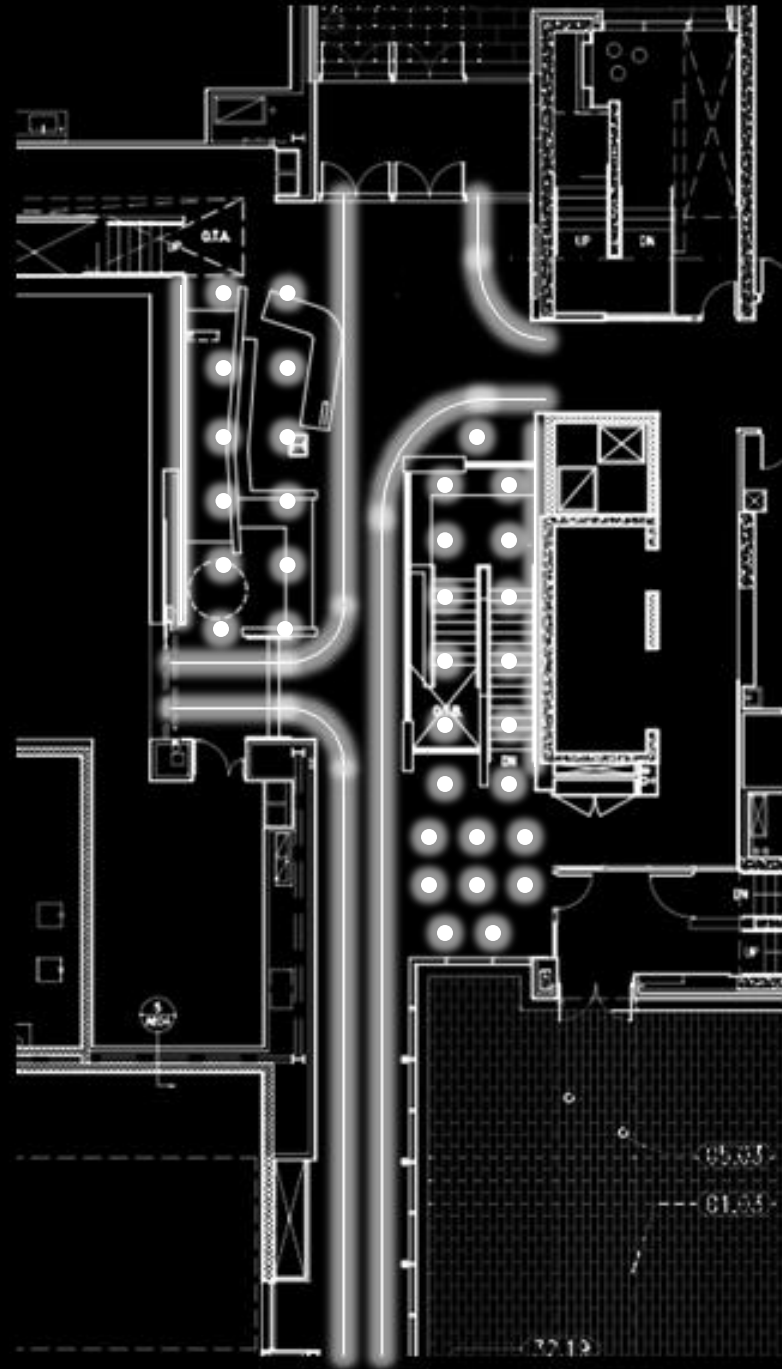
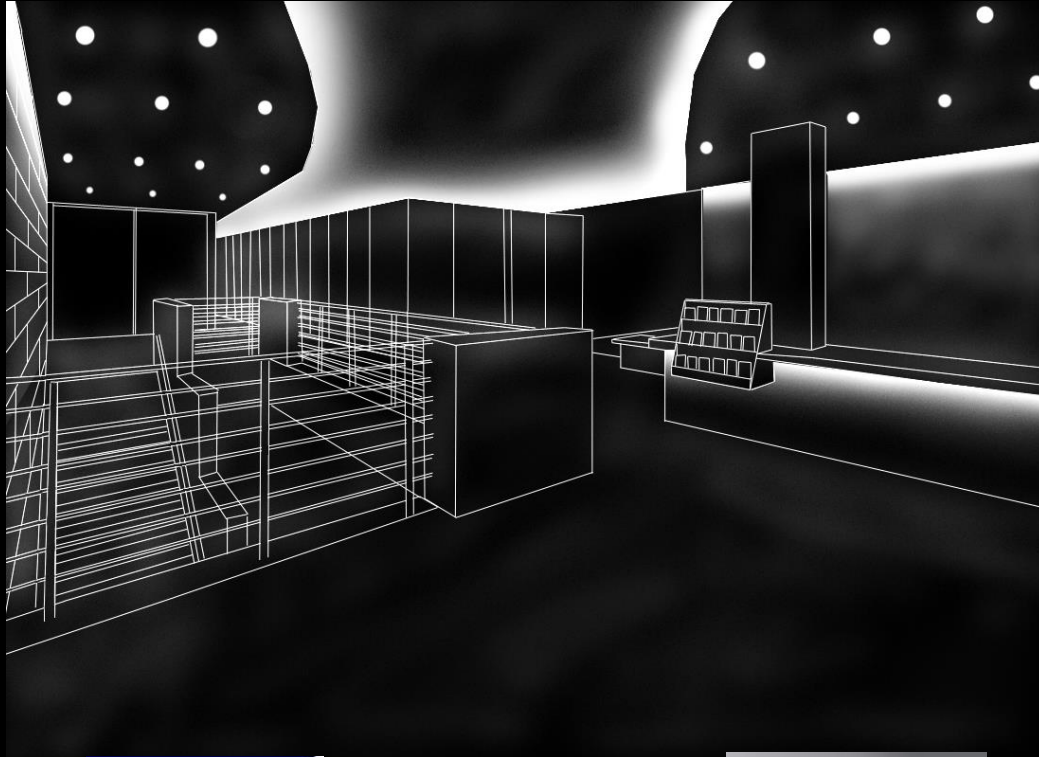

Performance Penthouse



Space purpose

- Performances
- Dance
- Classroom
- Banquet

Design goal

- Integrate daylight into the space
- Lighting control for various activities
- Provide Adequate illumination levels
- Uniform light distribution

Performance Penthouse | Cultural



Performance Penthouse

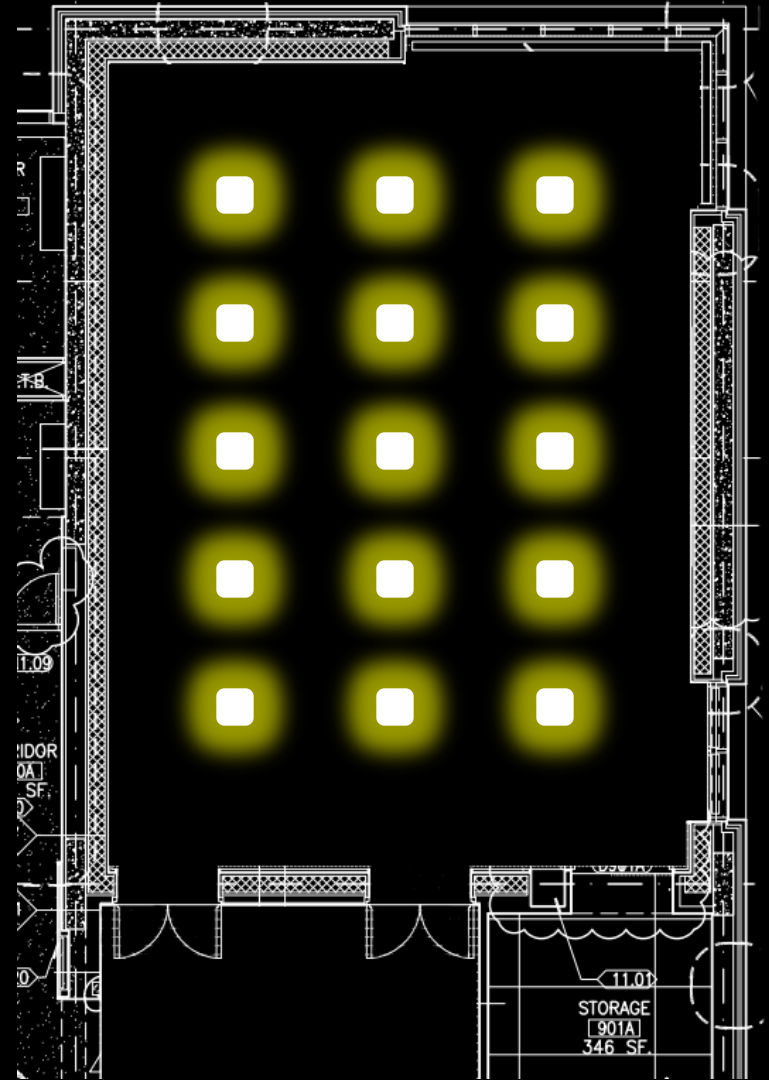
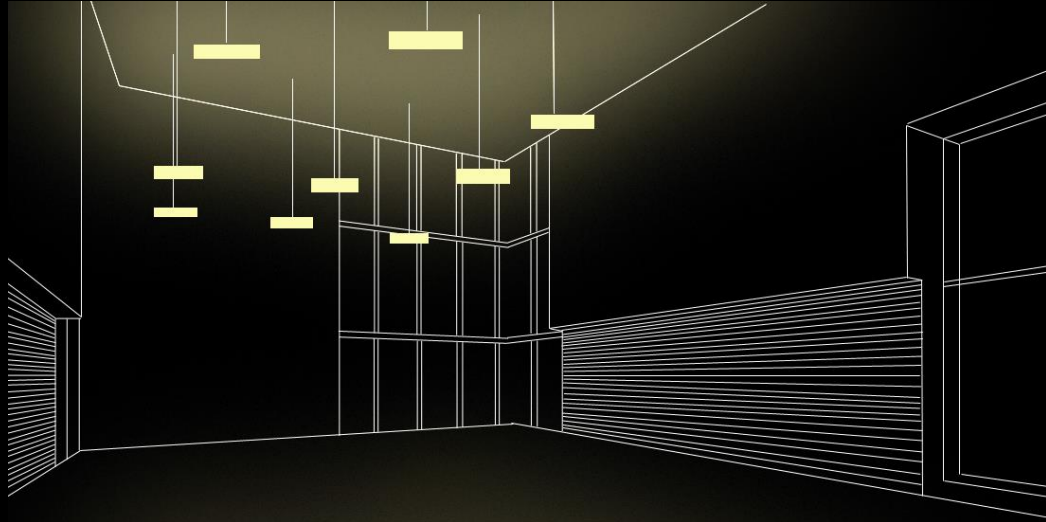

Performance Penthouse

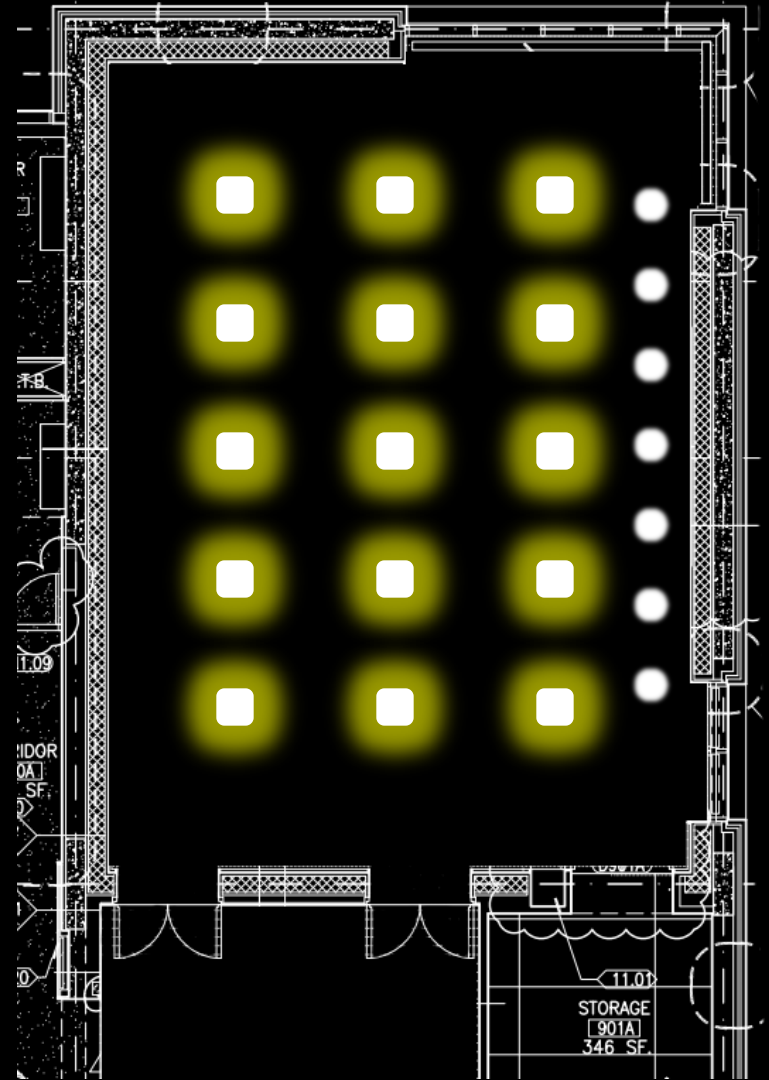
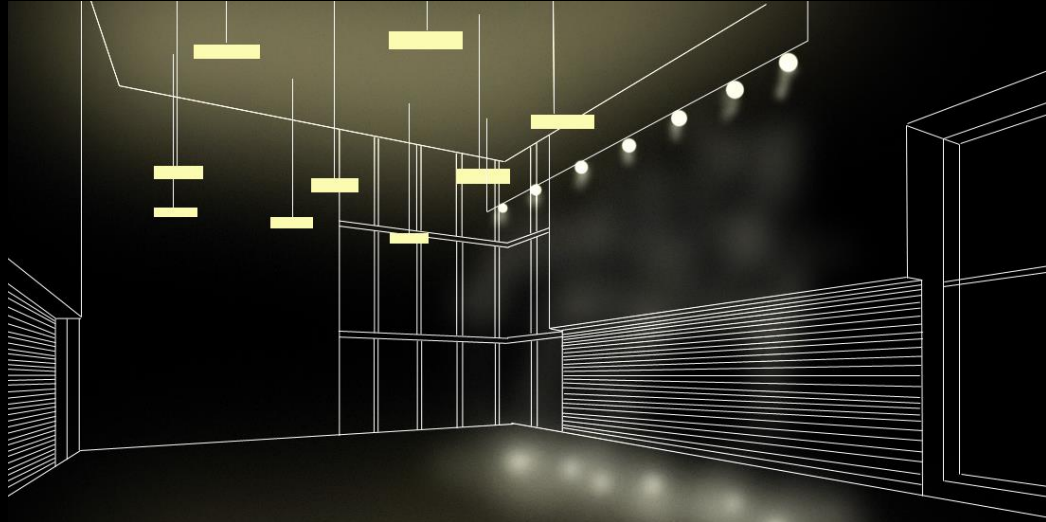

Performance Penthouse

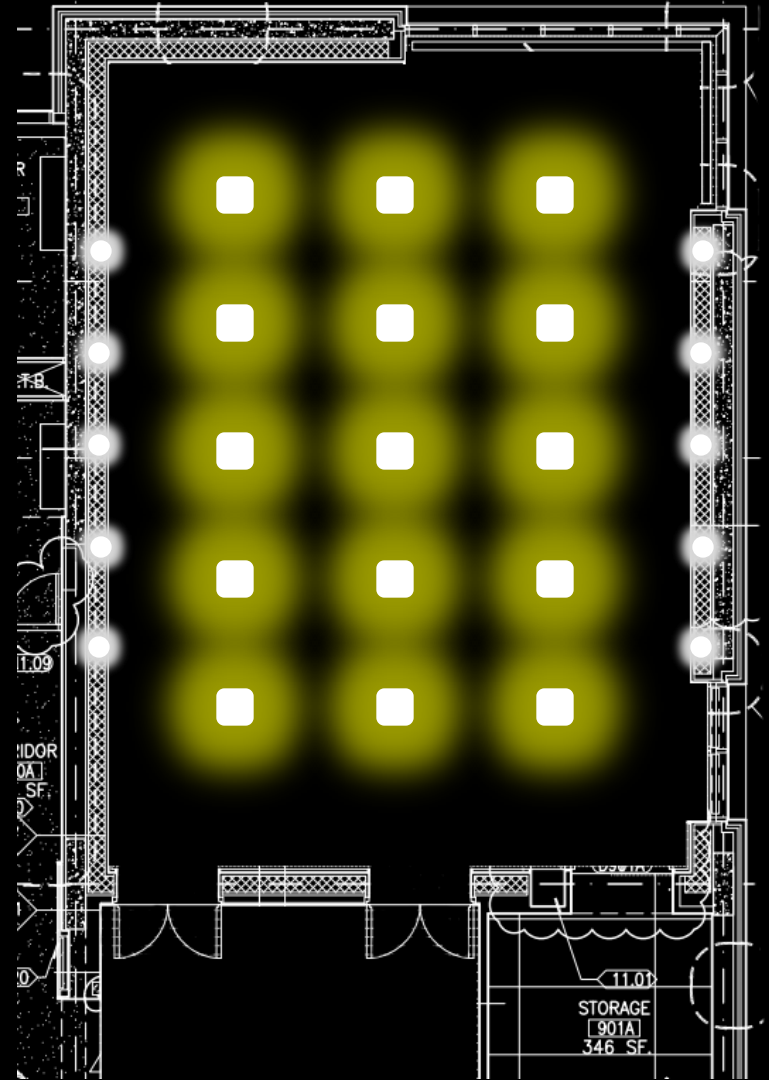
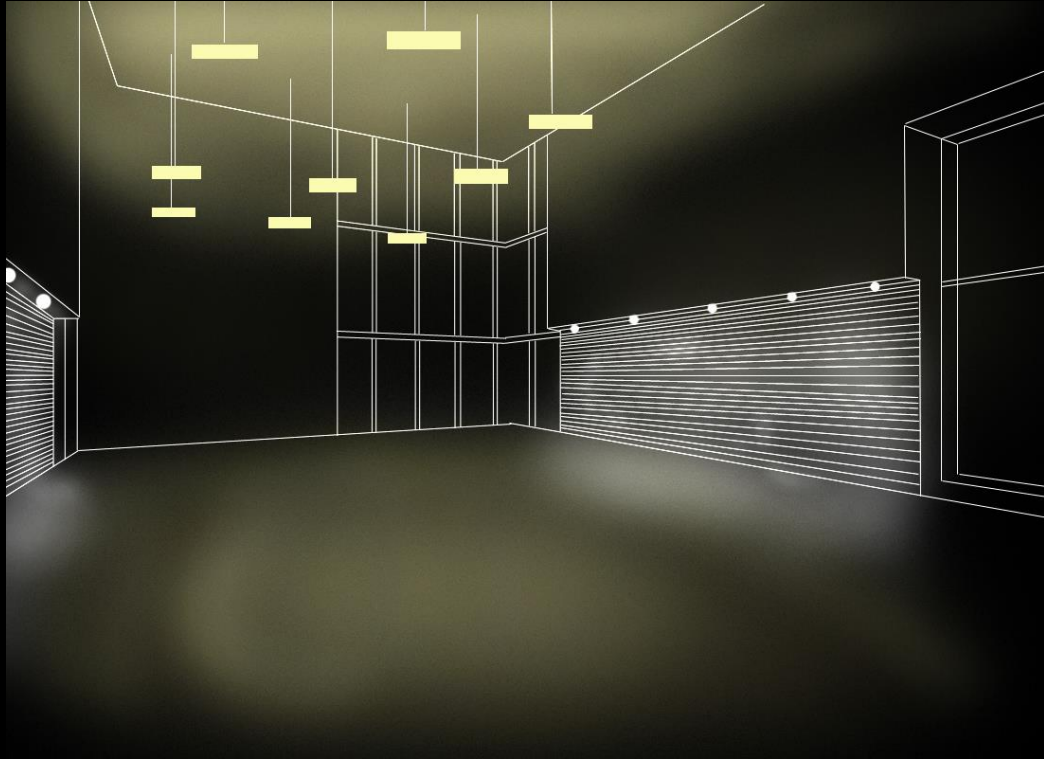

Performance Penthouse

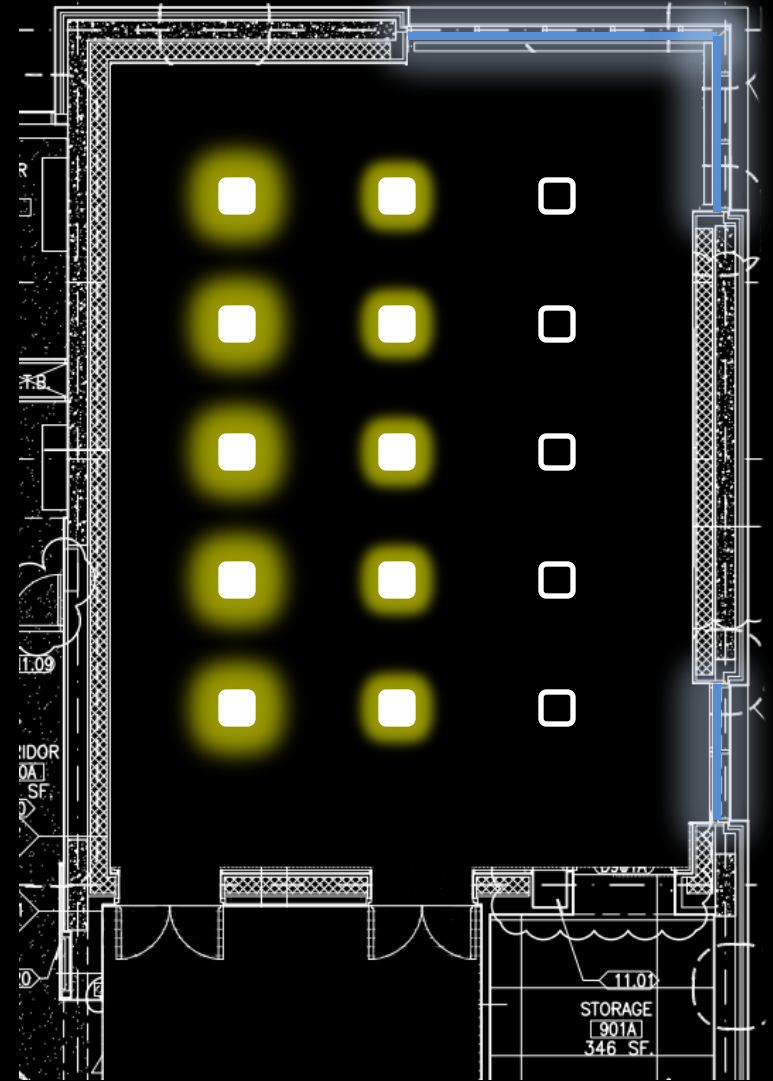
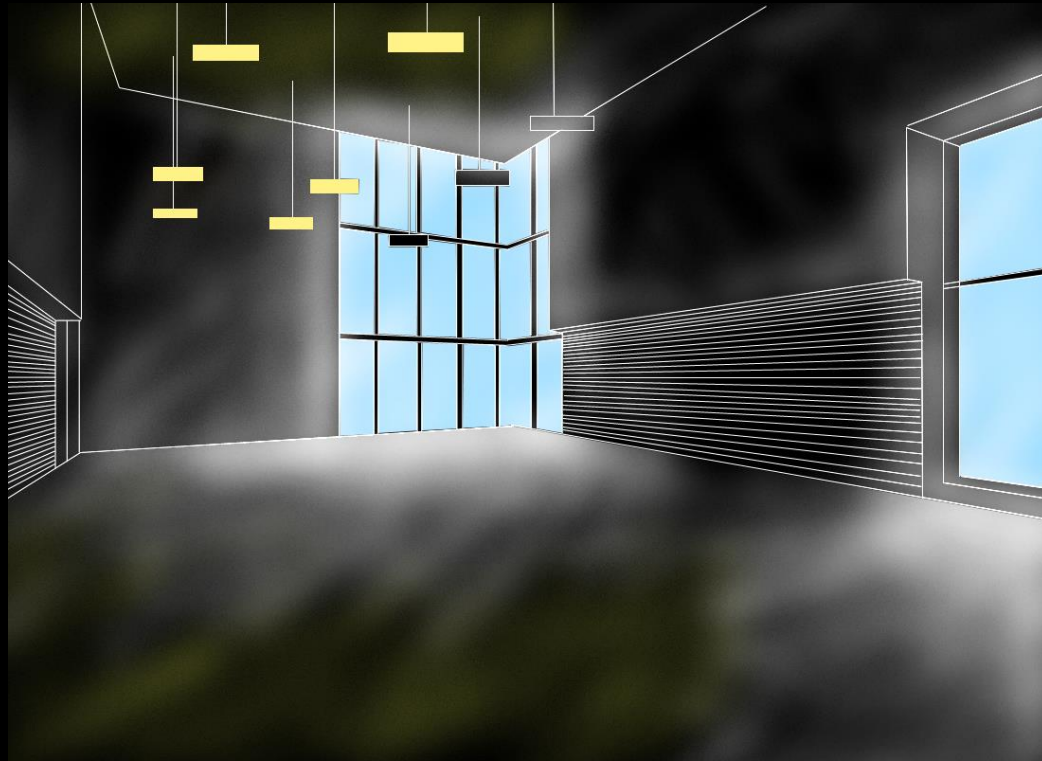

Courtyard



Space purpose

- Pathway
- Rest Area
- Outdoor performance

Design goal

- Provide light for way finding
- Adequate light for outdoor performance
- Avoid light trespass into the building
- Give relaxation feeling



Courtyard

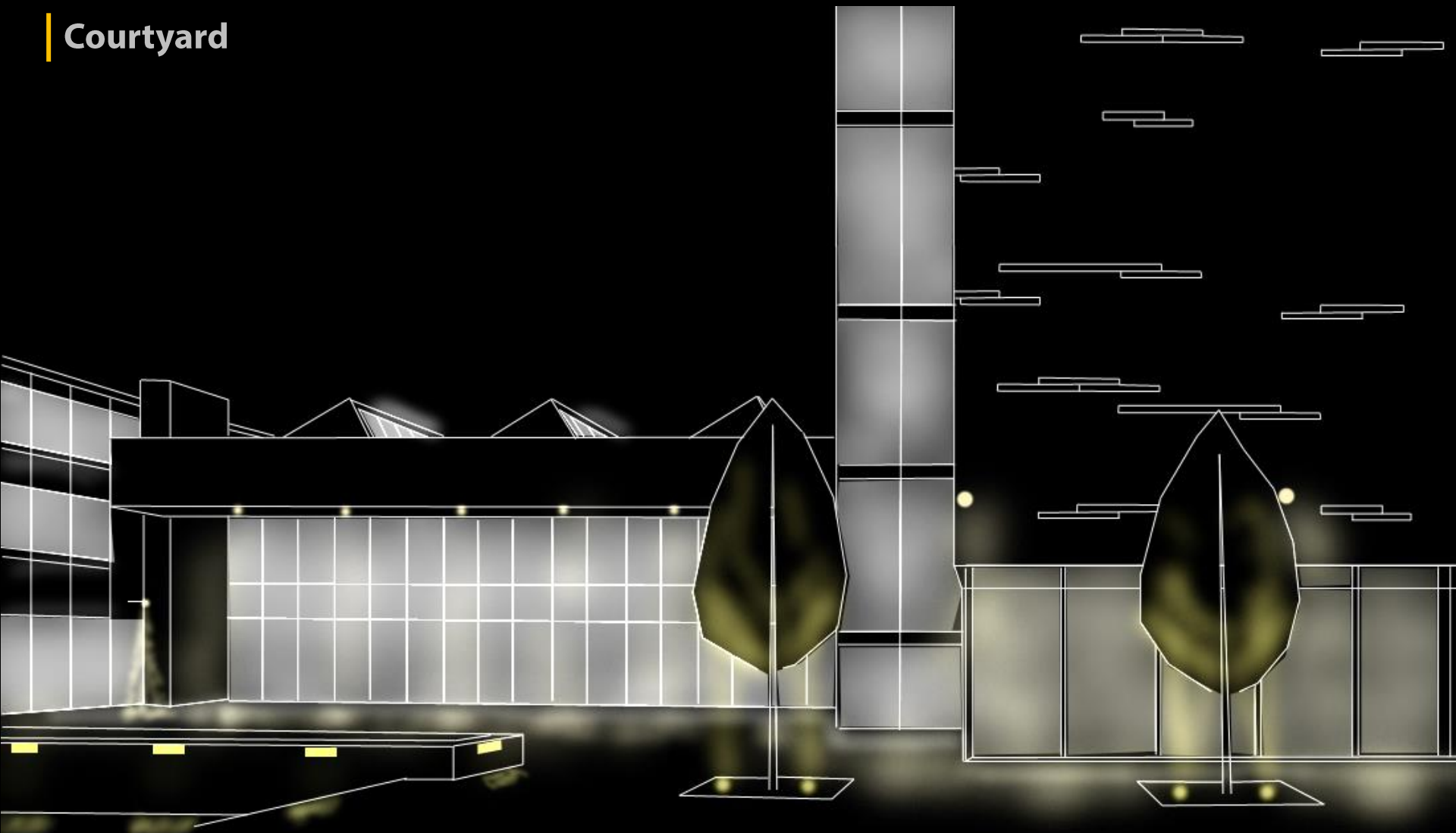

Courtyard

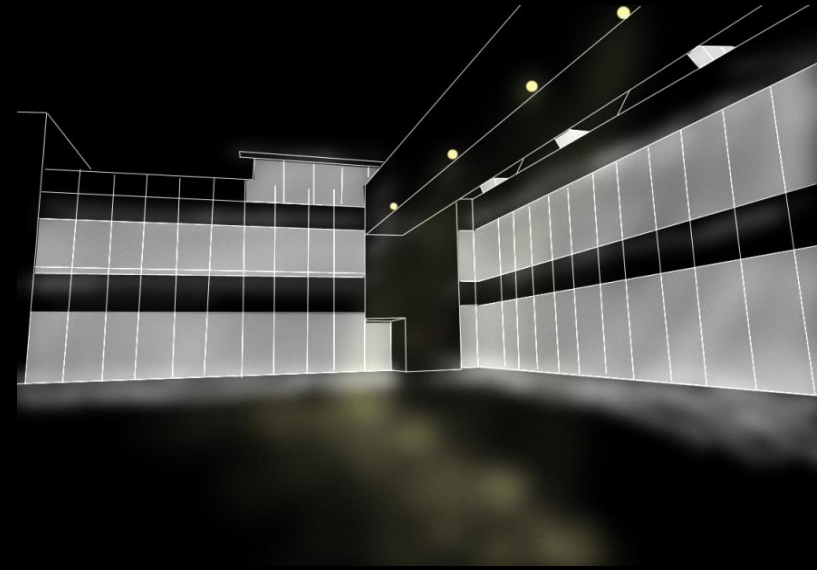
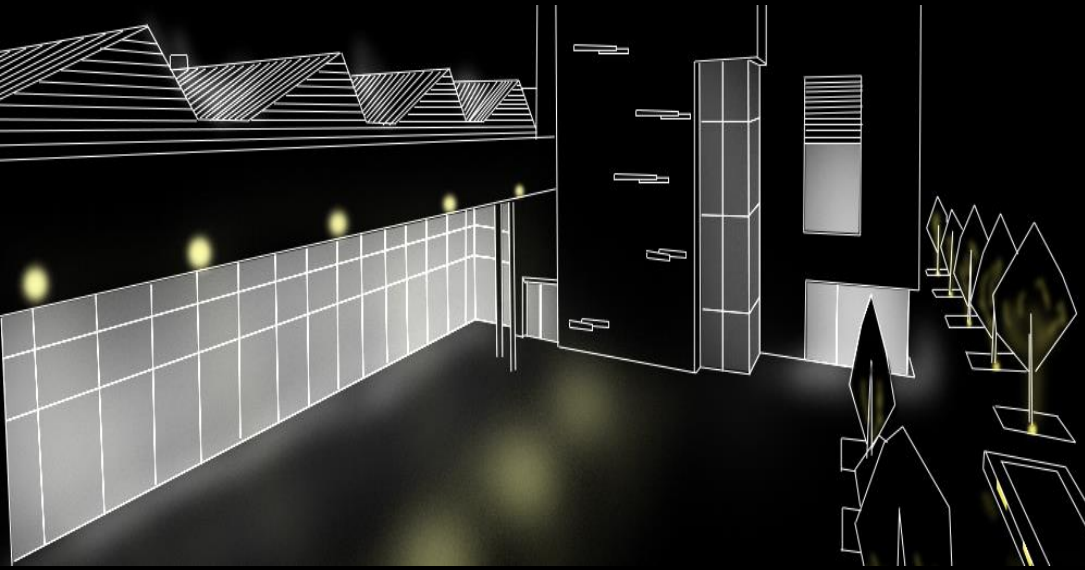

Performance Hall



Space purpose

- Performance
- Full orchestra
- Music, Dance, and Film

Design goal

- Flexible lighting for various activities
- Uniform light distribution with comfort
- Avoid visual distractions.
- Pleasant environment with relax atmosphere



Application

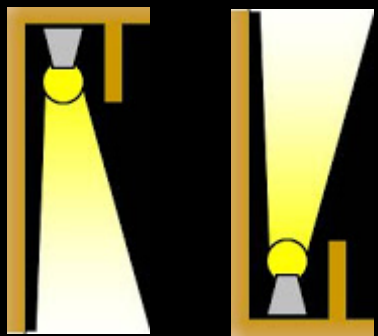

Performance Hall | Egress Lighting

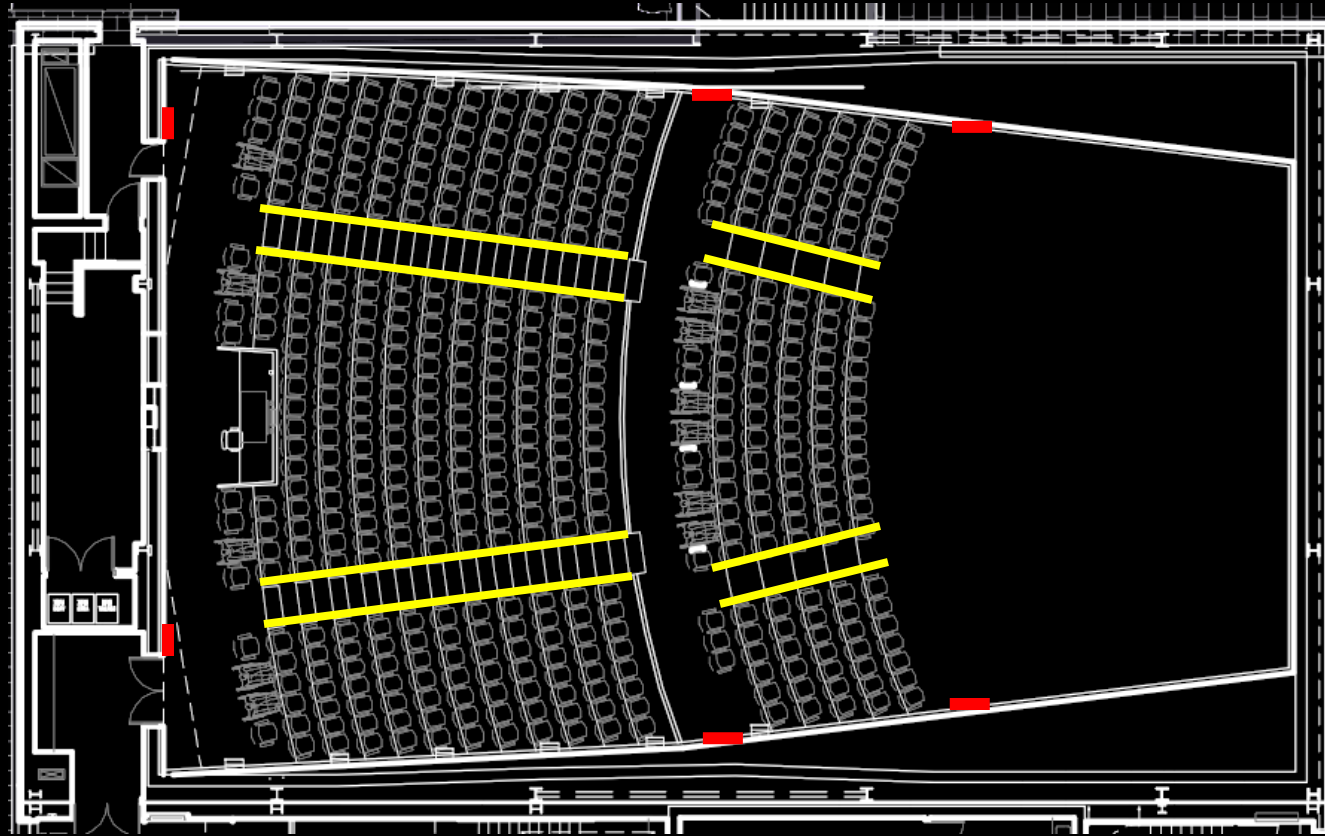

LED Seat Light



Recess wall "Exit" & "Stairs"

Performance Hall - Sophisticated

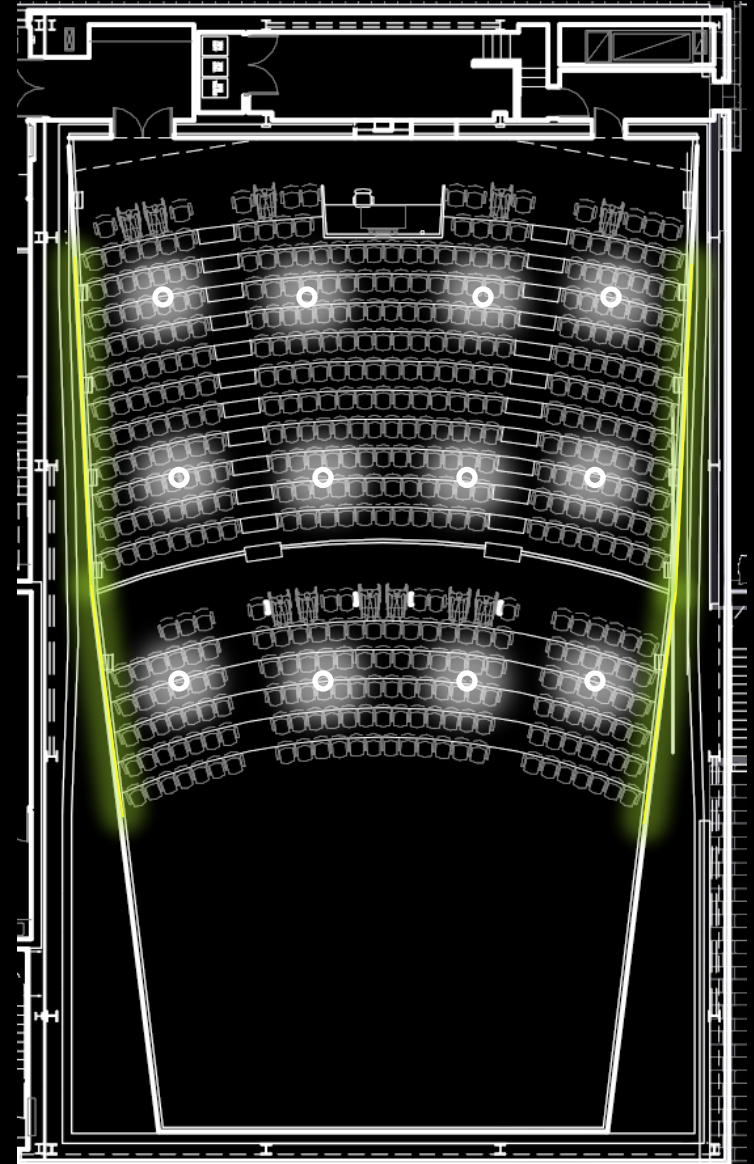
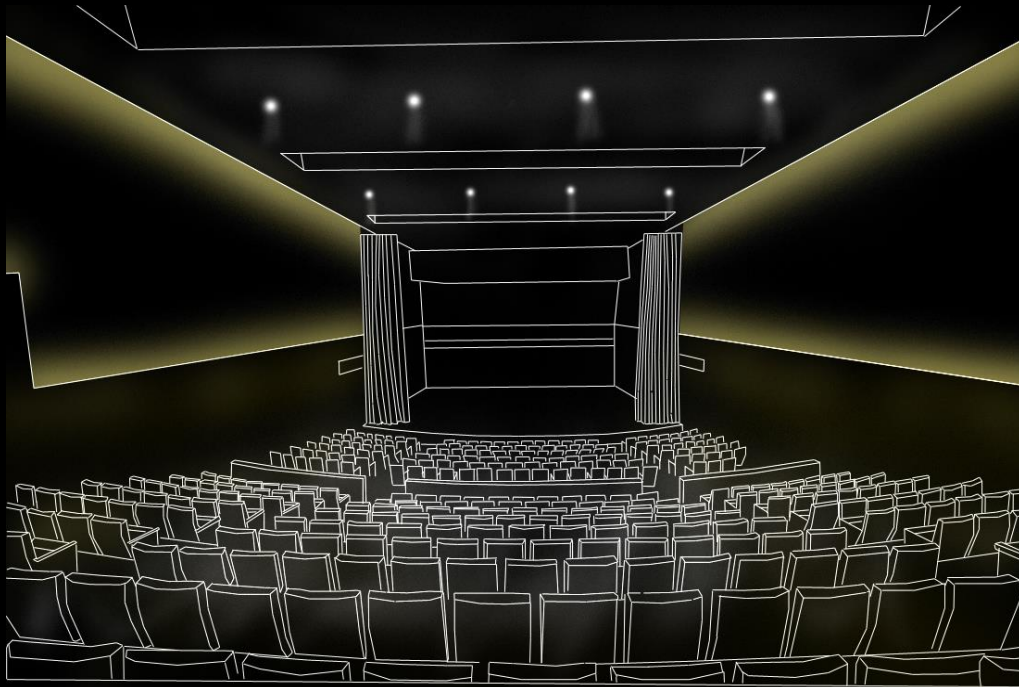

Performance Hall - Sophisticated

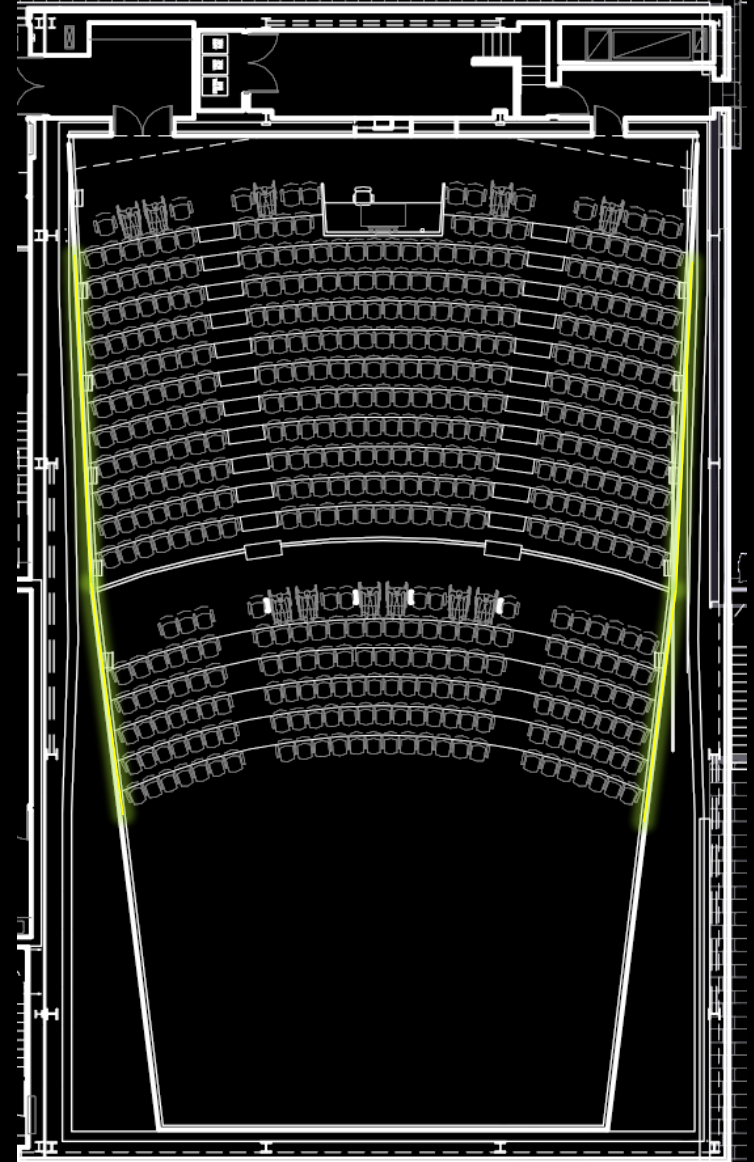
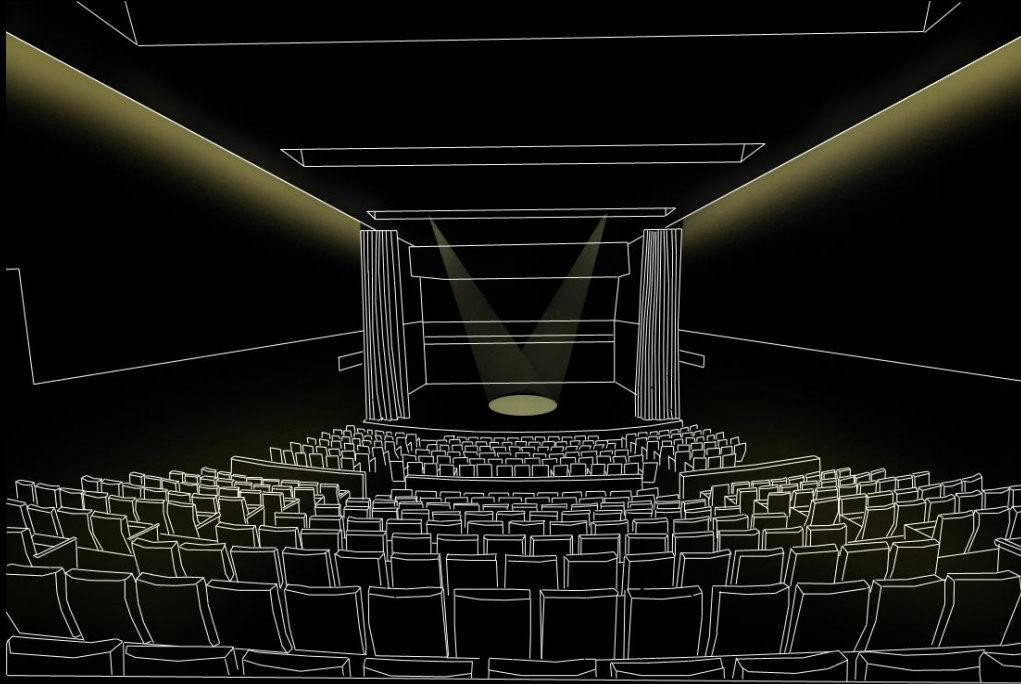

Performance Hall - Modernism

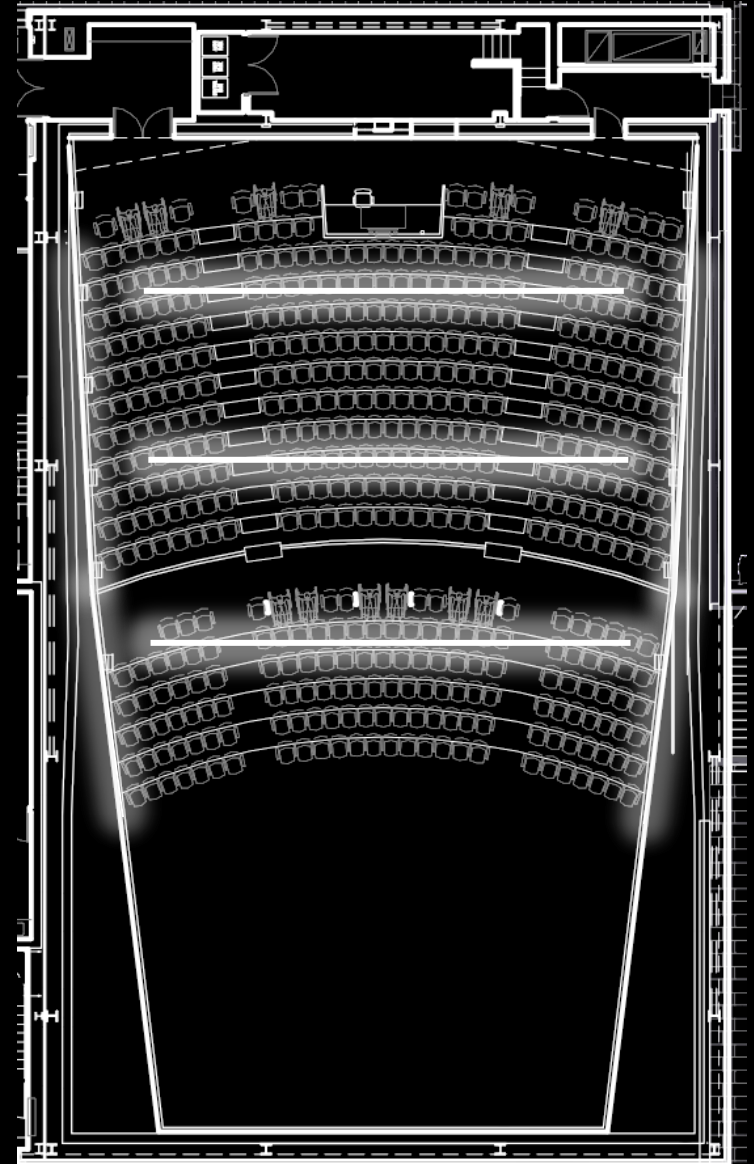
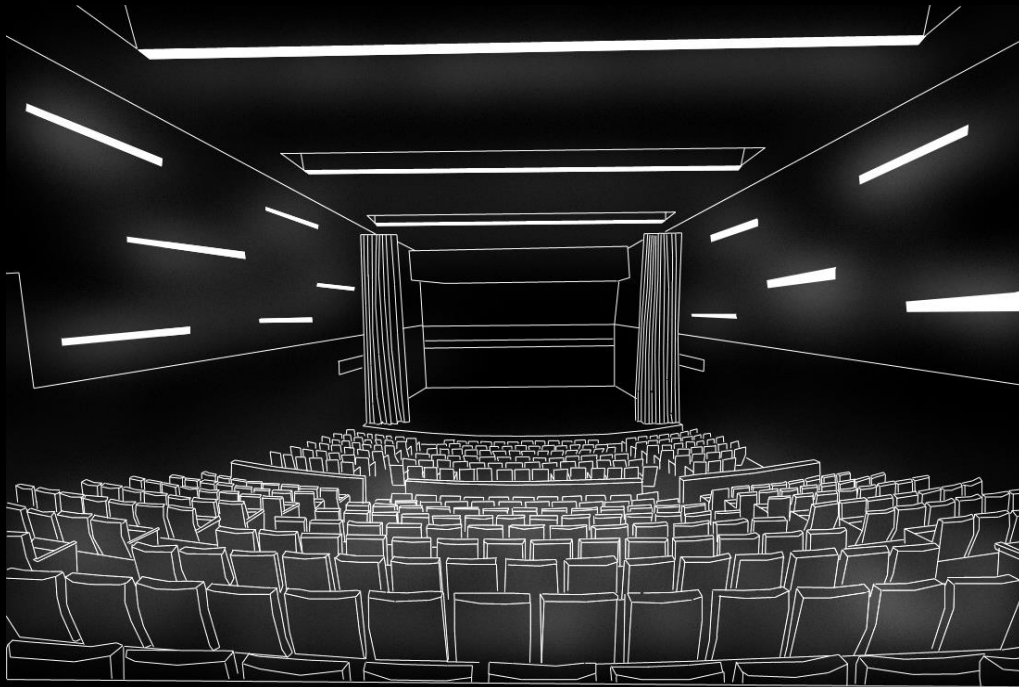

Performance Hall - Modernism

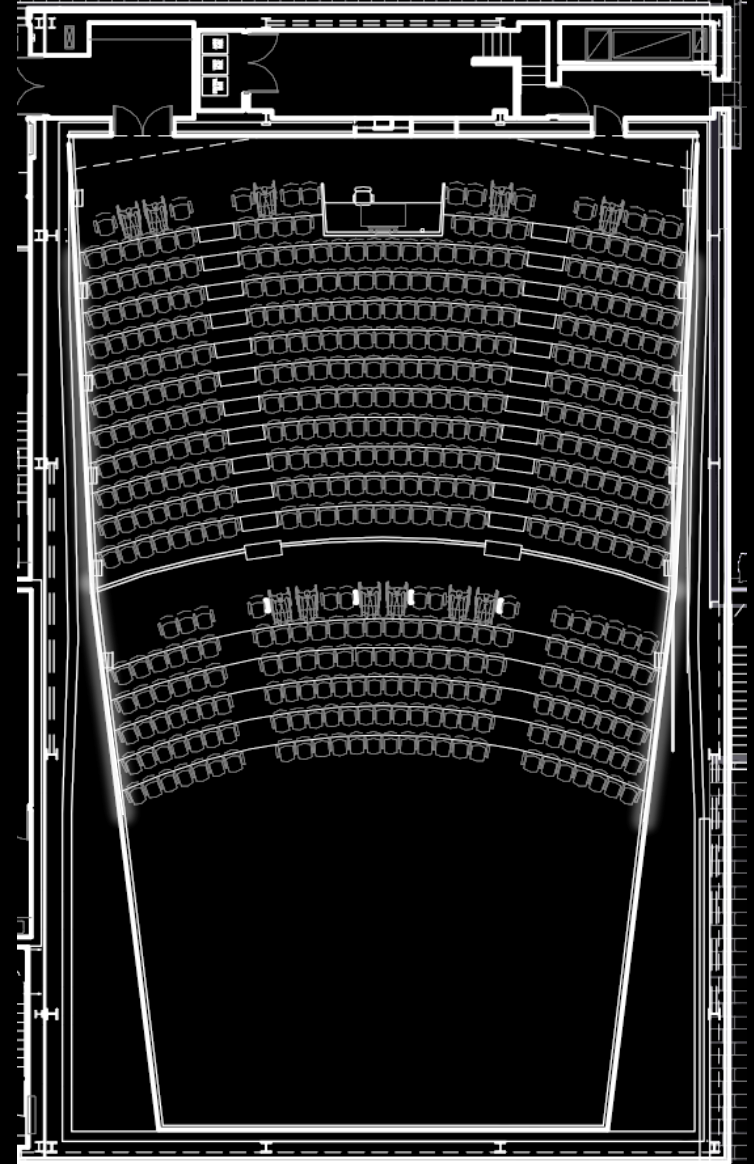

Performance Hall - Classical

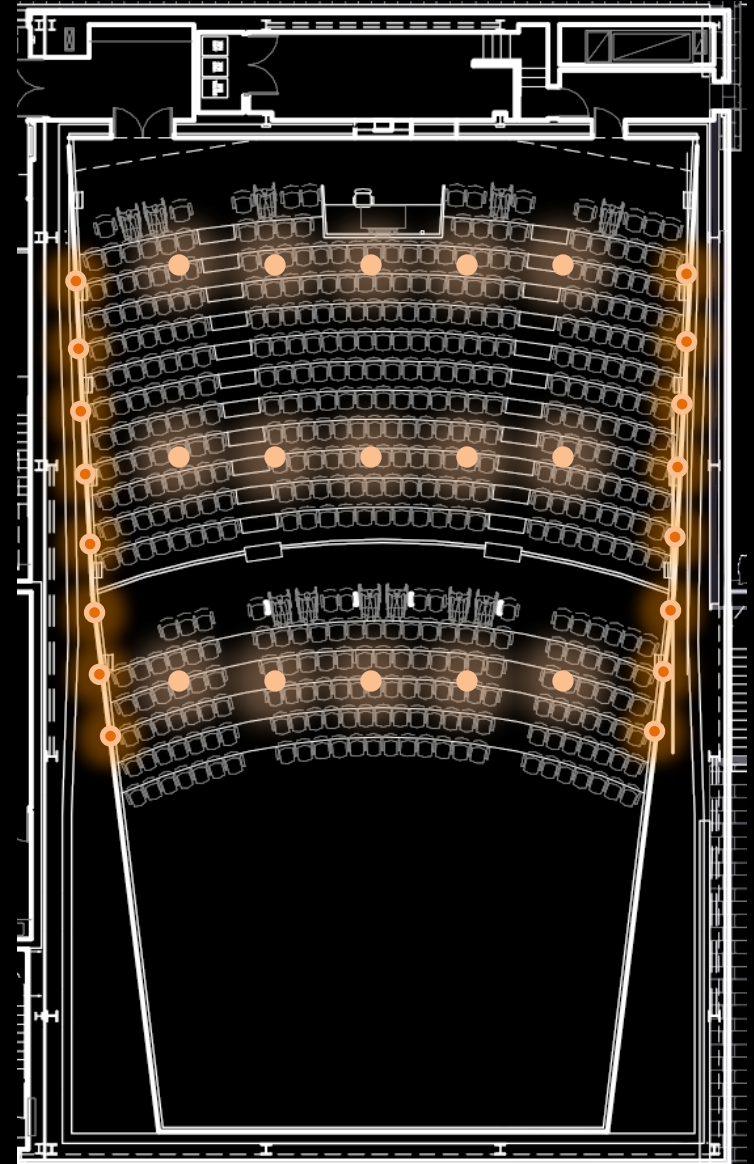
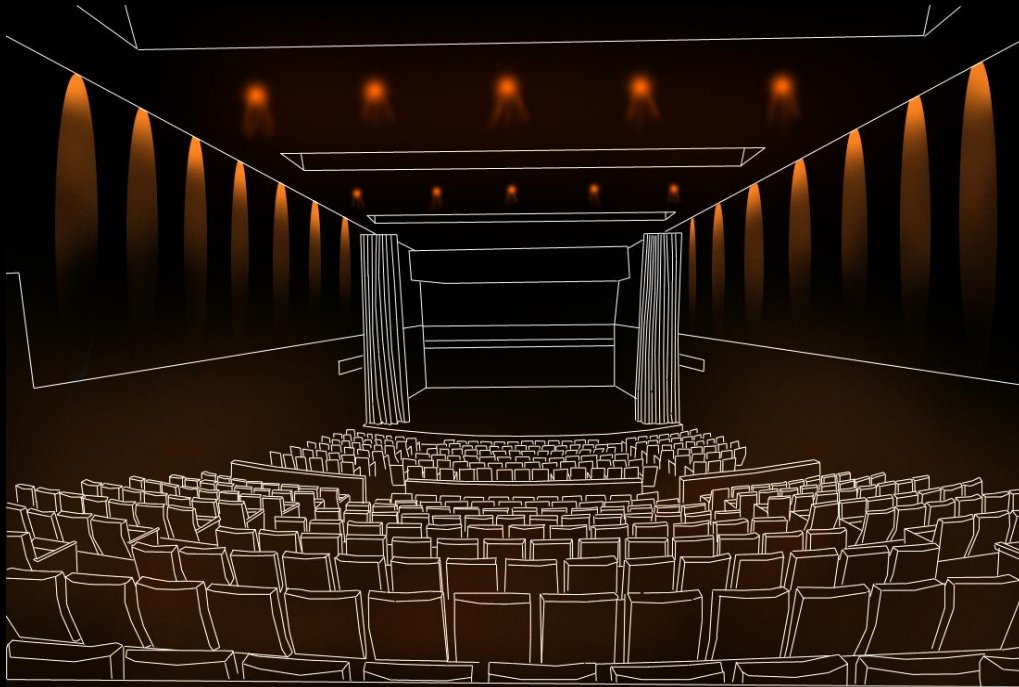

Performance Hall - Classical

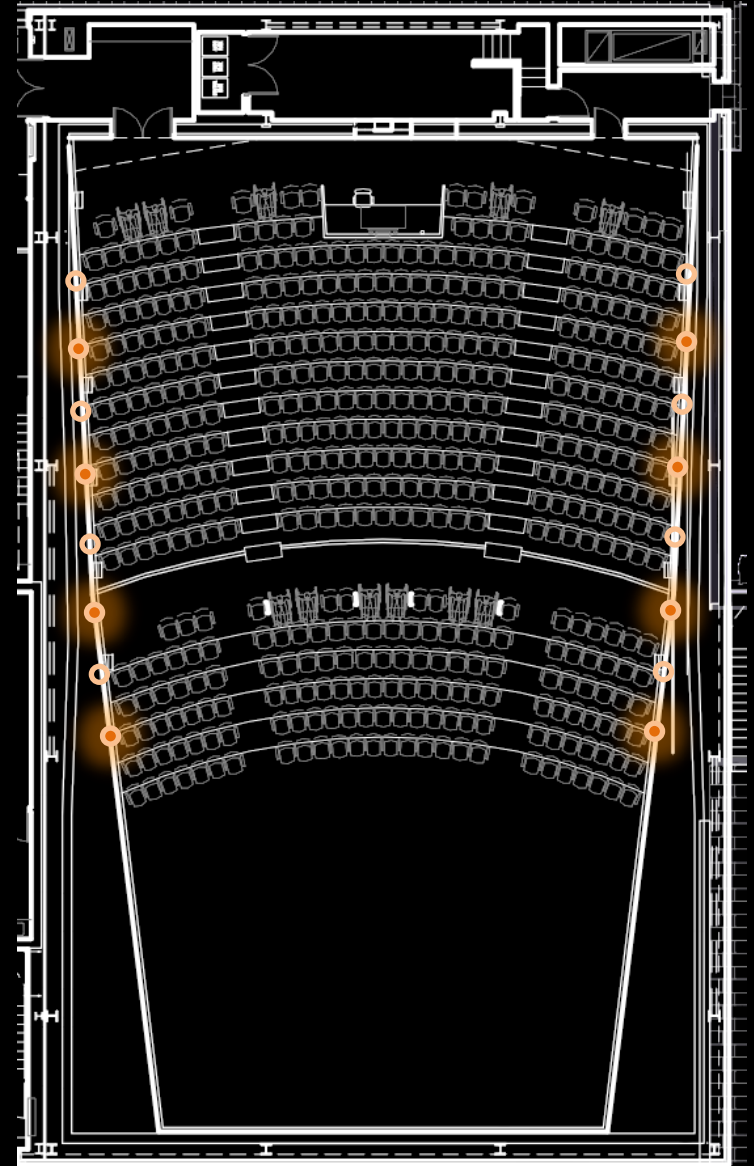
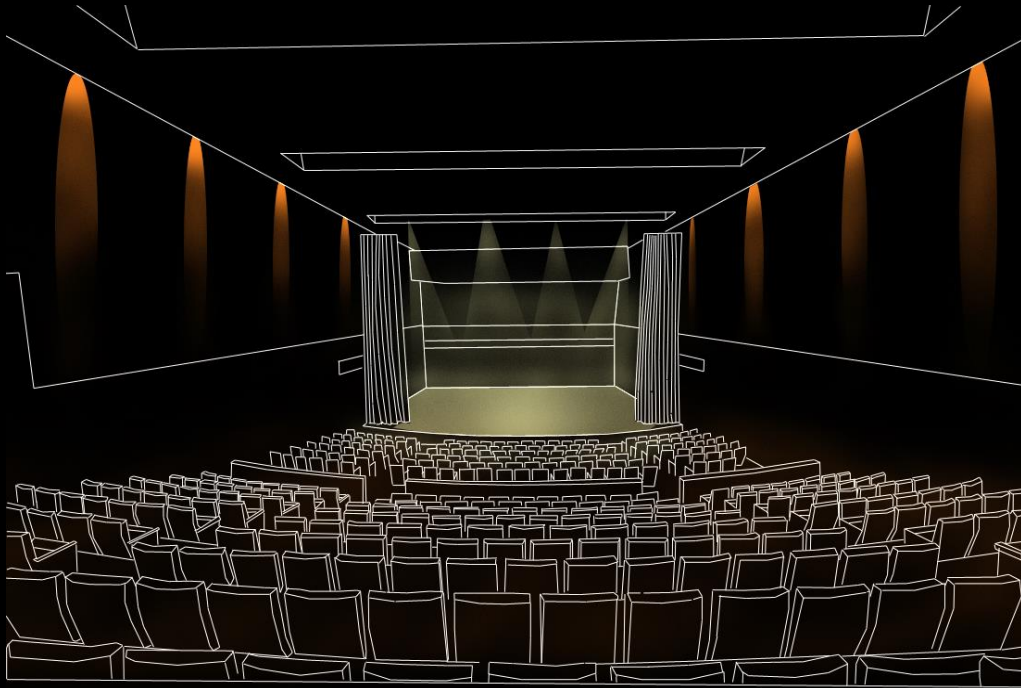

Thank you! & Questions?

